



KEY:

- = CMU Partition
- = Existing Partition
- = New Partition
- = Low Partition
- = Outlet Loc. Approx.
- = Ceiling Heights
- = Door Heights

STANDARD SPECIFICATIONS:

Partition - Free standing partitions to be 1/2" sheet rock over 3 5/8" metal stud with fiberglass insulation.

Mason walls - Existing to remain as is or furred out with 1 5/8" metal stud and 1/2" drywall when indicated on plan.

Doors - Existing doors shall remain U.O.N. (minimum door size shall be 3'-4 1/2" x 8'-1")

Ceiling - Existing suspended acoustical tile and light fixtures to remain U.O.N.

Electric - Existing to remain U.O.N. Standard private offices have 3 duplex outlets.

Millwork - Existing work surfaces and pantry millwork to remain U.O.N. Standard millwork material is plastic laminate.

Finishes - Existing finishes shall remain U.O.N. Standard wall paint is (typically) 2 coats of satin latex.

Special conditions at tenants cost not limited to upgrades & specialty HVAC.

GENERAL NOTES:

Meritt is not responsible for providing or installing appliances, phones, computer wiring, furniture and/or custom built-ins unless specified. Floor plan may be field adjusted due to existing conditions not shown on plan.

HC TOILET RM NOTES:

1. All fixtures to be ADA compliant
2. HC lav. Requirements:
 - low depth: 1'-5" min
 - toe clearance: 0'-6" max
 - knee clearance: 0'-8" min
3. HC rear 3'-0" wide grab bar mtd. 12" from corner, 2'-9" max above floor, side grab bars to be (1) 3'-6" bar 12" max. From corner, 3'-0" o/c above floor and (1) 1'-6" vertical bar, 3'-6" max. Above floor and 3'-6" o/c max. From corner per ans i 117.1-2003. G.C. To provide adequate blocking as required.
4. Wrap all exposed sink pipes.

AVAILABLE
06.21.24 (HLG)
50,308 SQFT TOTAL

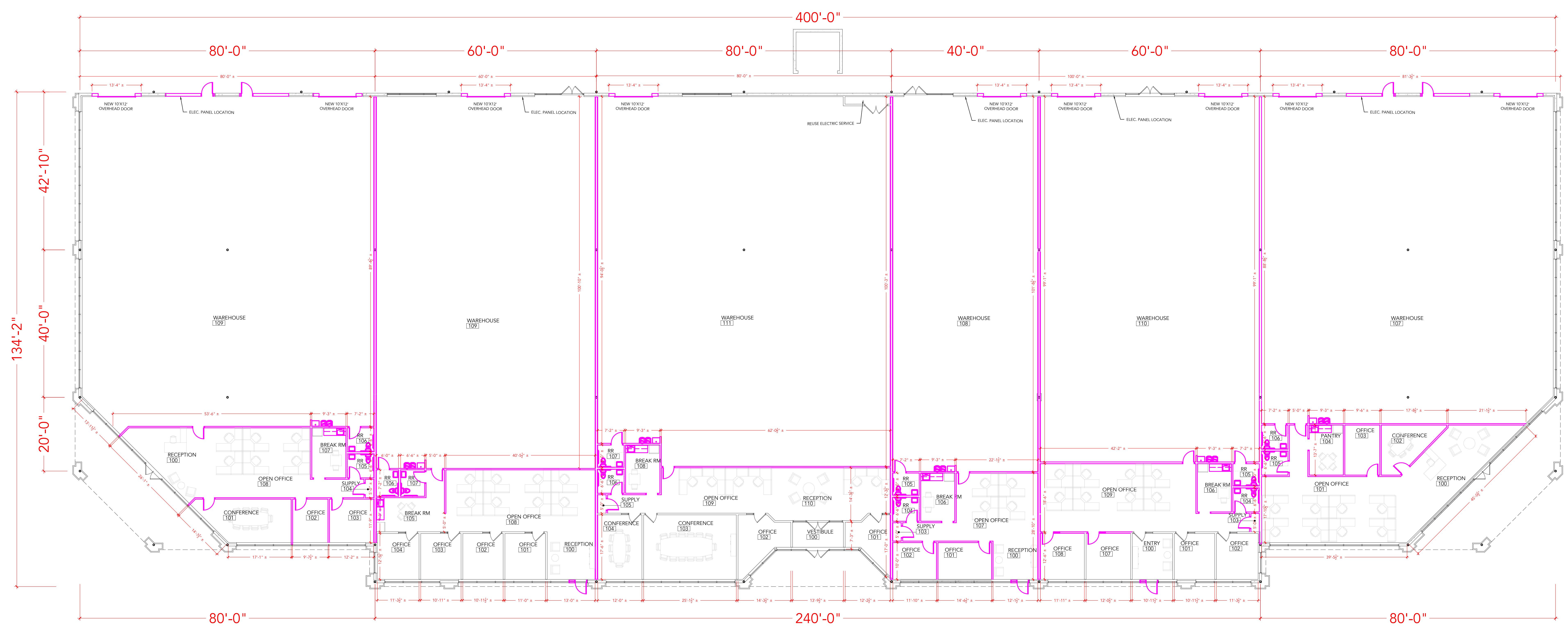

SUITES 401-402
 1,898 OFFICE SF
 7,336 WAREHOUSE SF
 9,234 TOTAL SF

SUITES 403-404
 1,928 OFFICE SF
 6,119 WAREHOUSE SF
 8,047 TOTAL SF

SUITES 405-406
 2,386 OFFICE SF
 8,008 WAREHOUSE SF
 10,394 TOTAL SF

SUITE 407
 1,239 OFFICE SF
 4,114 WAREHOUSE SF
 5,353 TOTAL SF

SUITES 408-409
 2,028 OFFICE SF
 6,016 WAREHOUSE SF
 8,044 TOTAL SF

SUITES 410-411
 1,956 OFFICE SF
 7,280 WAREHOUSE SF
 9,236 TOTAL SF

MERIDIAN
 5022 GATE PKWY,
 JACKSONVILLE FL 32256
 BUILDING 400

DATE	DESCRIPTION	BY

PROJECT NO:
 MERIDIAN BLDG 400
 ASBUILT DRAWN BY:
 XX
 SCALE:
 3/32" = 1"

TITLE:
 SPACE PLAN